



KUEBLER - MAGNET SENSOR LI20 WITH MAGNETIC RING RI20

SERIE 8.RI20

- Robust and able to withstand vibration
- Easy to install
- High resolution
- IP67. Impervious to chips, oil, water, etc.



PRODUCT DESCRIPTION

The combination RI20/LI20 is used to measure length via a rotary shaft, e.g. in woodturning machines, materials handling, overhead cranes, etc. This sensor is more or less totally impervious to chips, oil, dust and water and thus can be used in troublesome environments, it is sealed and has no moving parts. The sensor is fitted to read on a yoke. This yoke is available for shaft dimensions 8-30 mm. There are three different yoke sizes; 31 mm, 41.2 mm and 45 mm.

The yoke RI20 has a pole distance of 2 mm. The distance between the sensor and the yoke should be 0.1 to 1.0 mm (recommended 0.4 mm). For the magnet sensor, the slope must not exceed $\pm 3^\circ$, the rotation must not exceed $\pm 3^\circ$ and the offset must not exceed ± 1 mm.

The following information is required to select the right combination:

- yoke size
- max. shaft rotation speed (given the frequency to following systems)

Pulses/revolution	Yoke	Magnet sensor	Max. revolutions (rpm)
250	RI20.031.XXXX	LI20.11X1.2005	12000
1000	RI20.031.XXXX	LI20.11X1.2020	2400
2500	RI20.031.XXXX	LI20.11X1.2050	3900
1024	RI20.041.XXXX	LI20.11X1.2016	7000
360	RI20.045.XXXX	LI20.11X1.2005	12000
3600	RI20.045.XXXX	LI20.11X1.2050	2700

Please refer to the images below for ordering information.

Order code Sensor head Limes LI20		8.LI20.X1XX.2XXX Type a b c d e				
a Model 1 = IP67, standard 2 = IP68 / IP69k and humidity tested acc. to EN 60068-3-38, EN 60068-3-78	b Output circuit / power supply 1 = RS422 / 4.8 ... 26 V DC 2 = Push-pull / 4.8 ... 30 V DC	c Type of connection 1 = cable, 2 m [6.56'] PUR A = radial cable, special length PUR *) *) Available special lengths (connection type A): 3, 5, 8, 10, 15 m [9.84, 16.40, 26.25, 32.80, 49.21'] order code expansion .XXXX = length in dm ex.: 8.LI20.111A.2005.0030 (for cable length 3 m)	d Reference signal 2 = Index periodical	e Interpolation factor 005, 016, 020, 050	Stock types 8.LI20.1111.2005 8.LI20.1111.2020 8.LI20.1111.2050 8.LI20.1121.2005 8.LI20.1121.2020 8.LI20.1121.2050	

Order code
Magnetic ring RI20

8.R120	.	XXX	.	XXXX	.	111
Type		a		b		

Min. order quantity for non-stock types: 10 pieces

a *Outer diameter*

031 = 31 mm [1.22"]
041 = 41.2 mm [1.62"]
045 = 45 mm [1.77"]

b *Bore diameter*

0800 = 8 mm [0.32"]	1800 = 18 mm [0.71"]	0952 = 3/8"
1000 = 10 mm [0.39"]	2000 = 20 mm [0.79"]	1587 = 5/8"
1200 = 12 mm [0.47"]	2500 = 25 mm [0.98"] ³⁾	2540 = 1" ³⁾
1500 = 15 mm [0.59"]	3000 = 30 mm [1.18"] ³⁾	

Stock types

8.RI20.031.0800.111
8.RI20.031.1000.111
8.RI20.031.1200.111
8.RI20.031.1500.111
8.RI20.041.0800.111
8.RI20.045.1200.111
8.RI20.045.1500.111
8.RI20.045.2500.111
8.RI20.045.2540.111
8.RI20.045.3000.111

Order code		Year		Type		Reference signal		Stock type
Sensor head Lines L220		8	12	1	2	1	2	
		Year	Year	1	2	1	2	
1	Model			X	X	X	X	
2	IPNC standard							Stock type
3	IP68 / IP68 and humidity tested acc. to EN 60068-3-79							Stock type
4	Output circuit / supply power							Stock type
5	RoHS21 / A8 ... 28 V DC							Stock type
6	Order code							Stock type
7	Order code							Stock type
8	Order code							Stock type
9	Order code							Stock type
10	Order code							Stock type
11	Order code							Stock type
12	Order code							Stock type
13	Order code							Stock type
14	Order code							Stock type
15	Order code							Stock type
16	Order code							Stock type
17	Order code							Stock type
18	Order code							Stock type
19	Order code							Stock type
20	Order code							Stock type
21	Order code							Stock type
22	Order code							Stock type
23	Order code							Stock type
24	Order code							Stock type
25	Order code							Stock type
26	Order code							Stock type
27	Order code							Stock type
28	Order code							Stock type
29	Order code							Stock type
30	Order code							Stock type
31	Order code							Stock type
32	Order code							Stock type
33	Order code							Stock type
34	Order code							Stock type
35	Order code							Stock type
36	Order code							Stock type
37	Order code							Stock type
38	Order code							Stock type
39	Order code							Stock type
40	Order code							Stock type
41	Order code							Stock type
42	Order code							Stock type
43	Order code							Stock type
44	Order code							Stock type
45	Order code							Stock type
46	Order code							Stock type
47	Order code							Stock type
48	Order code							Stock type
49	Order code							Stock type
50	Order code							Stock type
51	Order code							Stock type
52	Order code							Stock type
53	Order code							Stock type
54	Order code							Stock type
55	Order code							Stock type
56	Order code							Stock type
57	Order code							Stock type
58	Order code							Stock type
59	Order code							Stock type
60	Order code							Stock type
61	Order code							Stock type
62	Order code							Stock type
63	Order code							Stock type
64	Order code							Stock type

Order code	8.R120	.XXX	.XXXX	.111	Min. order quantity for non-stock types: 10 pieces
Magnetic ring R120	Type				
Order diameter	900 ± 0 mm [3.15"]	1000 ± 18 mm [3.71"]	800 ± 38"		Stock types
941 ± 0 mm [3.71"]	1000 ± 18 mm [3.71"]	2000 ± 28 mm [3.71"]	1000 ± 58"		#R120.01.0800.111
945 ± 0 mm [3.72"]	1200 ± 22 mm [4.71"]	2000 ± 28 mm [3.71"]	2540 ± 1"		#R120.01.1200.111
945 ± 0 mm [3.72"]	1500 ± 12 mm [3.91"]	2000 ± 28 mm [3.71"]			#R120.01.1500.111
		2000 ± 28 mm [3.71"]			#R120.01.2000.111
					#R120.01.2540.111
					#R120.01.3000.111

Pin assignment:

Signal	Wire colour
0 V, GND	white
U_B	brown
A	green
\overline{A}	yellow
B	grey
\overline{B}	pink
I	blue
\overline{I}	red

Shield is on the housing

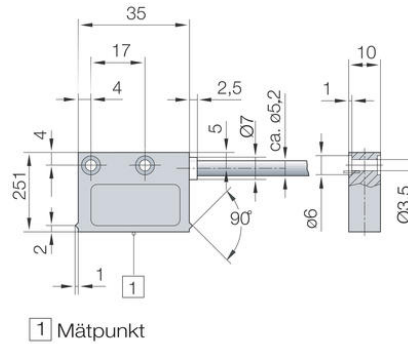
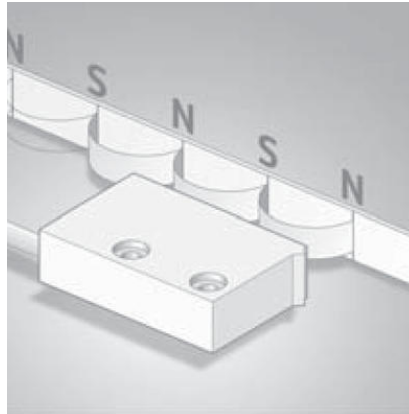
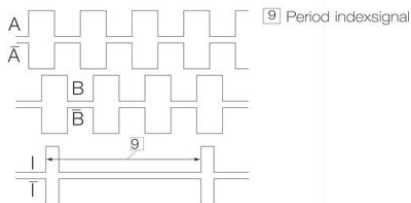

Magnetring 8.RI20.031.XXXX.111, ø 31 mm

